

Titus



**System 5
Cam5000**

System 5

Cams and Dowels

Ø15mm Cam5000

- Improved central shape for highly resistant joint
- Suitable for use with all Titus dowels
- 'Klix' locking feature provides a strong, vibration proof joint
- Cam retaining pips ensure that a cam is held in panel position prior to assembly

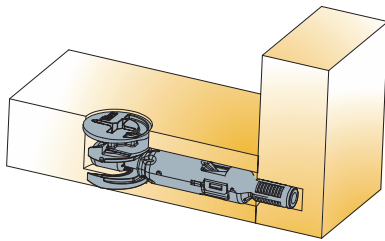

Technical and mounting details

B	D	e	h	Item number	Zinc	Noir
Panel thickness	Drilling depth	Drilling for dowel	Cam height			
12/13	10.5	6 min	9.9	09695 →	885	
15/16	12.5	7.5-8	11.9	09690 →	885	

Cam5000 cross drive

PZ2 drive

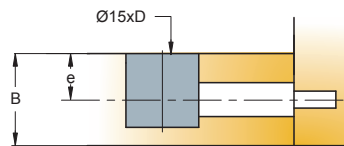
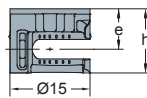

1000 Pcs

Made of zinc

Cam5000 hexagonal drive

combined drive with HEX

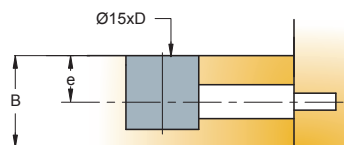
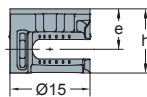

15/16	12.5	7.5-8	11.9	09699 →	885	
18/19	14	9-9.5	13.2	09692 →	885	
22/23	16	11-11.5	15.2	09332 →	885	
25/26	18	12.5-13	16.7	09335 →	885	
28/29	19.5	14-14.5	18.2	09336 →	885	

Noir available upon request

1000 Pcs
500 Pcs (9335, 9336)

Made of zinc



Cover caps for Ø15 cams
Made of plastic

→ See page 1.65 Furniture Fittings System catalogue

System 5

Cams and Dowels

Ø15mm Cam3000 S

- Innovative design offers optimal performance with maximum cost effectiveness
- Suitable for use with Combi dowels and Quickfit dowels
- 'Klix' locking feature provides a strong, vibration proof joint
- Cam-retaining pins ensure that a cam is held in panel position prior to assembly

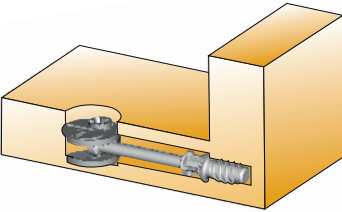

Technical and mounting details

B	D	e			
Panel thickness	Drilling depth	Drilling for dowel	Item number	Zinc	Zinc corrosil

Cam3000 S/15

PZ2 drive 

15/16	12.5	7.5-8	09491 →	885	897
-------	------	-------	----------------	-----	-----

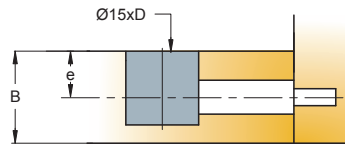
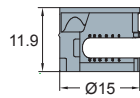

 1000 Pcs

Made of zinc

Cam3000 S/12

PZ2 drive 

12 min	9.5 min	min 6	*09406 →	885	897
--------	---------	-------	-----------------	-----	-----

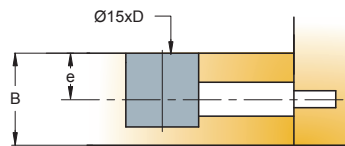
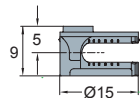

** European market only*

 2000 Pcs

Made of zinc

Cam3000 S/12

Philips PH2 drive 

12 min	9.5 min	min 6	*09631 →	885	
--------	---------	-------	-----------------	-----	--

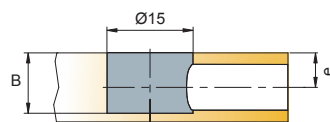
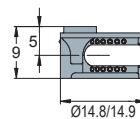

** American market only*

 1000 Pcs

Made of zinc



Cover caps 09630
Made of plastic

System 5

Cams and Dowels

Ø15mm Cam5000

- Improved central shape for highly resistant joint
- Suitable for use with all Titus dowels
- 'Klix' locking feature provides a strong, vibration proof joint
- Cam retaining pips ensure that a cam is held in panel position prior to assembly

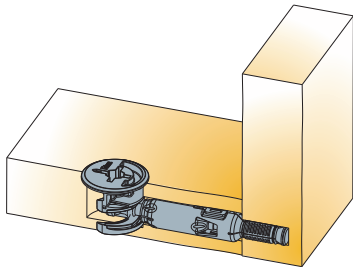

Technical and mounting details

Cam5000 headed cross drive

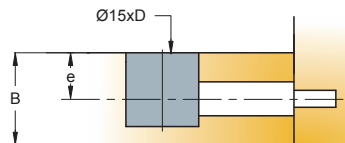
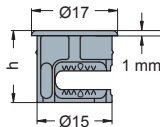

1000 Pcs

Made of zinc

Cam5000 headed hexagonal drive

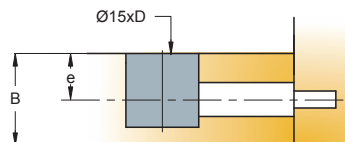
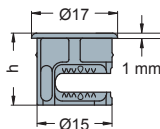

1000 Pcs
500 Pcs (9337)

Made of zinc

B	D	e	h	Item number	Nickel	Zinc	Noir
Panel thickness	Drilling depth	Drilling for dowel	Cam height				

12	10min	6	9.9	09330 →		885	
----	-------	---	-----	---------	--	-----	--

Noir available upon request

16	13	8	12.4	09333 →	847	885	
19	14.5	9.5	13.9	09334 →	847	885	
29	19.5	14.5	18.9	09337 →		885	

Noir available upon request

System 5 Cams and Dowels

Ø12mm Cam2000

- Suitable for all Titus screw-in dowels, not suitable for Quickfit dowels
- Available in a variety of head, drive recess and board thickness versions to suit most applications
- Particularly suited to drawer front attachment applications
- 'Klix' locking feature provides a strong, vibration proof joint
- Linear cam profile results in smooth, easy cam rotation and dowel pull-up

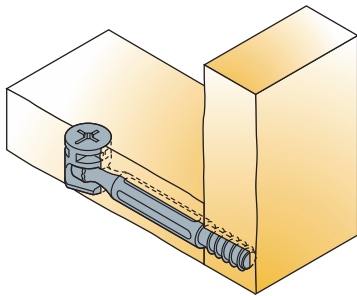

Technical and mounting details

Cam2000
Ø12mm

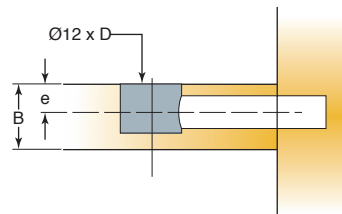
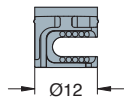

2000 Pcs

Made of zinc

Cam2000
Ø12mm headed

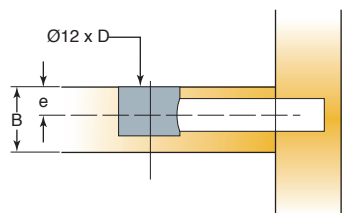
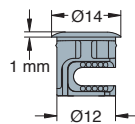

1000 Pcs
2000 Pcs (05576)

Made of zinc

B	D	e			
Panel thickness	Drilling depth	Drilling for dowel	Item number	Nickel plated	Corrosil zinc
12/13	10 min	6-6.5	05575 →	847	885
15/16	12	7.5-8	05578 →		885
18/19	13 min	9-9.5	05580 →		885







Other finishes on request

12	9.2 min	5.25	05574 →	847	885
12	10 min	6	05576 →		885
16	12.5	8	05579 →		885

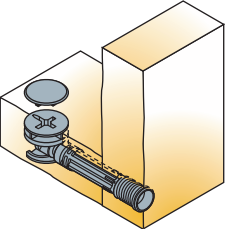
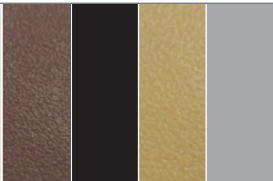
Other finishes on request

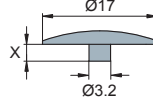
System 5 Cover Caps

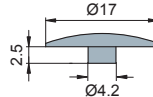
- Available in a variety of colours
- Suitable for pozi and hex cam drive

	X	Item number				
			Dark brown	Black	Light brown	Light grey
Technical and mounting details	Pin length	Item number	Dark brown	Black	Light brown	Light grey
Cover cap Ø17 for PZ2 drive  	3.3	*01029 →	834	835	867	882
	2.5	277-4355 →	370	390	330	380
<i>*American market only Other colours on request</i>						
 1000 Pcs	Made of plastic					
Cover cap Ø17 for HEX drive  		277-4225 →	370	390	330	380
	<i>Other colours on request</i>					
 1000 Pcs	Made of plastic					

Your authorized dealer